



Contact:
Steve Vogel • 417.434.1900

COMMERCIAL PROPERTY RESTAURANT LOCATION FOR SALE

RESTAURANT LOCATION OPPORTUNITY

JOPLIN, MISSOURI



- PROPERTY LOCATION** 3129 East Hammons Boulevard • Joplin, Missouri
 The subject property is a free-standing building conveniently located on a pad lot near the SW corner of Interstate 44 & Business Highway 71.
 Surrounding retail establishments include: John Q. Hammons Convention Center, Holiday Inn, Hampton Inn, Sam’s Club, Olive Garden, & Outback Steakhouse.
- BUILDING** Building: 8,490 Sq. Ft. (Kitchen: 2,225 Sq. Ft.)
 Sprinkler System
 Seating 250
- ZONING** Retail with the City of Joplin. This zoning accomodates: drive-thru windows, restaurants, banks, general retail, gasoline convenience stores, etcetera.
- TRAFFIC COUNTS**

<u>Interstate 44 / East -West</u>	<u>Business 71 @ Interstate 44</u>
30,284	25,280
- TRADE AREA** The City of Joplin has a trade area of some 450,000 people within a 50-mile radius (see demographics).
- PARKING SPACES** 106
- CONTACT INFORMATION** Steve Vogel 417.434.1900



◆ VOGEL PROPERTY

⬡ HOTELS

1 MOTEL 6

2 FAIRFIELD INN

3 RAMADA INN

4 COMFORT INN & SUITES

5 DAYS INN

6 BEST WESTERN

7 SELECT HALLMARK

8 BAYMONT HOTEL

9 SUPER 8

10 BEST VALUE

11 HAMPTON INN

12 DRURY INN

13 RESIDENCE INN

14 HOLIDAY INN

● RESTAURANTS

1 APPLEBEE'S

2 RED LOBSTER

3 RUBY TUESDAY'S

4 DENNY'S

5 OLIVE GARDEN

6 OUTBACK STEAKHOUSE

7 STEAK-N-SHAKE

8 CHEDDAR'S

9 CRACKER BARREL

● OTHER BUSINESSES

1 OFFICE DEPOT

2 CONTINENTAL AUTO MALL

3 CFI HEADQUARTERS

4 FOOD-4-LESS

5 SOUTHSIDE SHOPPING CTR

6 BKD ACCOUNTING FIRM

7 SAM'S CLUB

8 JOH CONVENTION CENTER

9 GALLERIA SHOPPING CTR

10 FAG BEARINGS HDOTRS



Contact:
Steve Vogel • 417.434.1900

COMMERCIAL PROPERTY RESTAURANT LOCATION FOR SALE

CONCEPT IMAGES: MODIFICATIONS OF CURRENT DESIGN

This building can easily be converted to suit a restaurant of any cuisine.





Contact:
Steve Vogel • 417.434.1900

COMMERCIAL PROPERTY RESTAURANT LOCATION FOR SALE





Contact:
Steve Vogel • 417.434.1900

COMMERCIAL PROPERTY RESTAURANT LOCATION FOR SALE





Contact:
Steve Vogel • 417.434.1900

COMMERCIAL PROPERTY RESTAURANT LOCATION FOR SALE





Contact:
Steve Vogel • 417.434.1900

COMMERCIAL PROPERTY RESTAURANT LOCATION FOR SALE



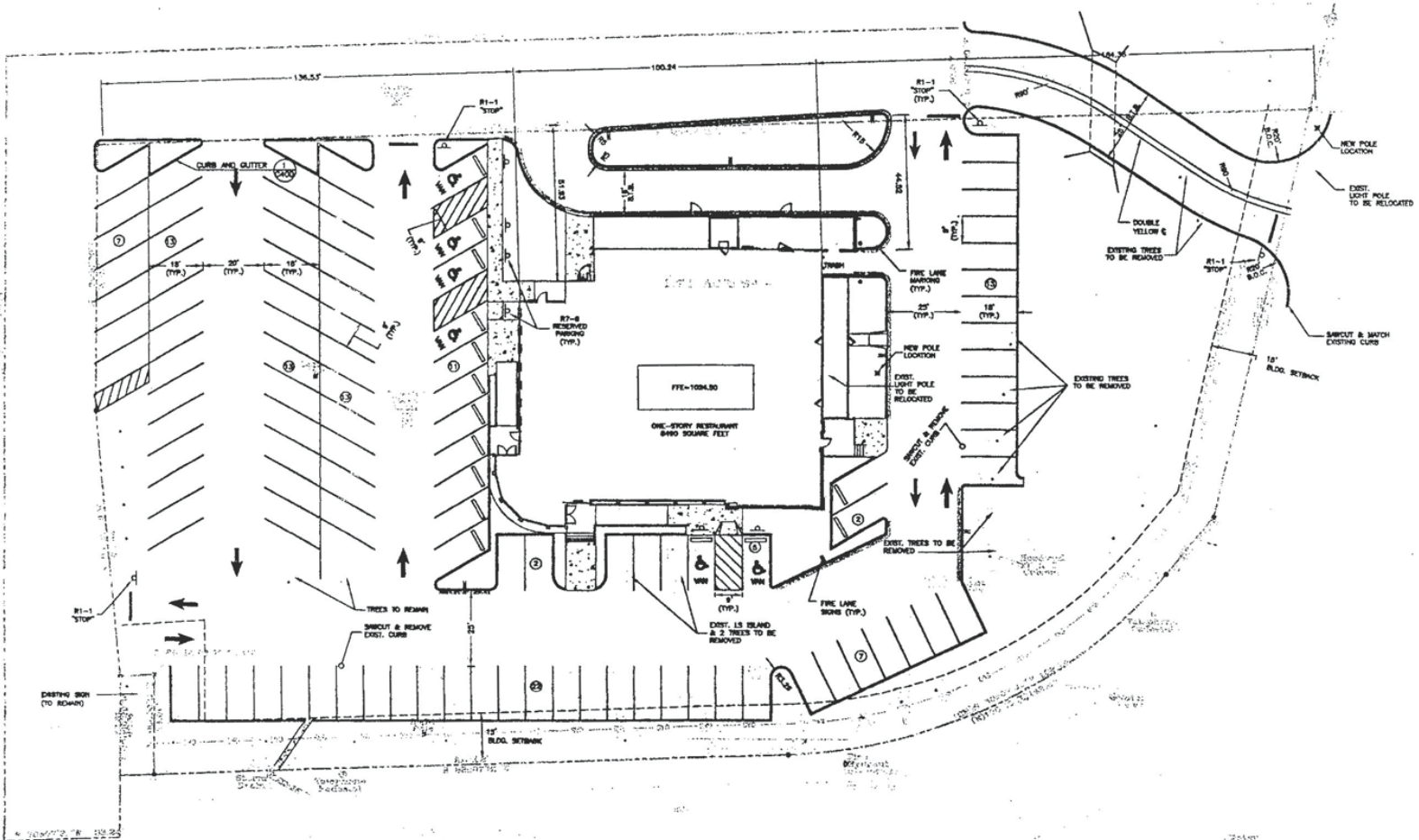

Atkins Benham
 501-770-3600
 www.atkinsbenham.com
 a member of the W. Attkin group of companies



Marketplace Grill
John Q. Hammons Blvd.
Joplin, Missouri
Site Plan

DESIGNED BY	DAG
DRAWN BY	TDD
APPROVED BY	GLC
DATE	10/31/01
SCALE	1"=20'
PROJECT NUMBER	

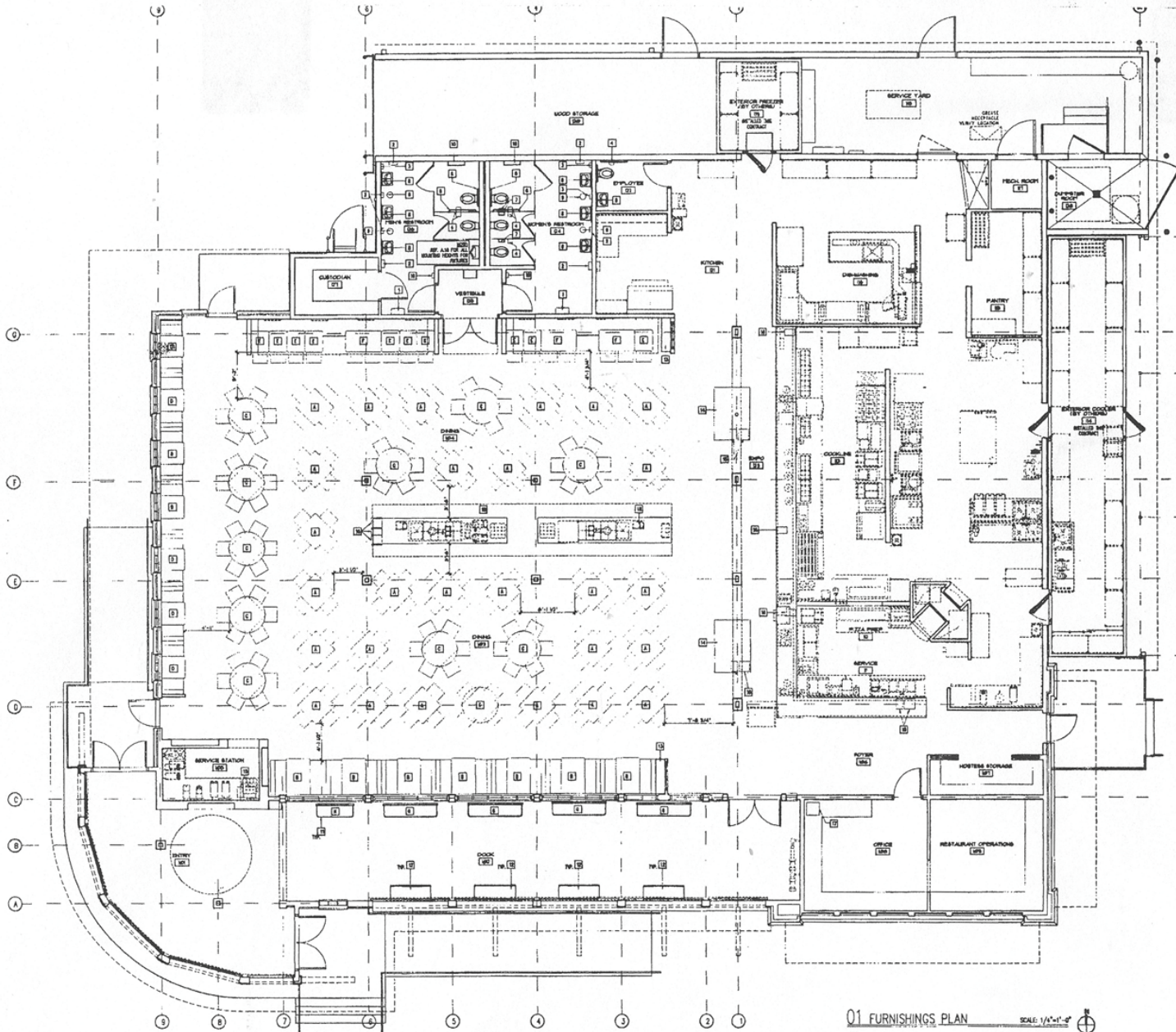

KEYNOTES

- 1 SURFACE-MOUNTED WHITE REFRIGERATOR, 60" WIDE
- 2 TUBULAR SEWER, 8" DIA.
- 3 SURFACE-MOUNTED WHITE REFRIGERATOR, 60" WIDE
- 4 TUBULAR SEWER, 8" DIA.
- 5 SURFACE-MOUNTED WHITE REFRIGERATOR, 60" WIDE
- 6 TUBULAR SEWER, 8" DIA.
- 7 12" DIA. GAS, BRASS, 6" HEIGHT
- 8 12" DIA. GAS, BRASS, 6" HEIGHT
- 9 SURFACE-MOUNTED TUBULAR SEWER, 8" DIA.
- 10 TUBULAR SEWER, 8" DIA.
- 11 METAL PANEL, BRASS, 6" DIA.
- 12 METAL PANEL, BRASS, 6" DIA.
- 13 CLASSICAL BRASSING ALUMINUM TRIM, RESPONSIVE TO
- 14 METAL, BRASS, CLASSICAL BRASSING ALUMINUM TRIM, RESPONSIVE TO
- 15 METAL, BRASS, CLASSICAL BRASSING ALUMINUM TRIM, RESPONSIVE TO
- 16 METAL, BRASS, CLASSICAL BRASSING ALUMINUM TRIM, RESPONSIVE TO
- 17 METAL, BRASS, CLASSICAL BRASSING ALUMINUM TRIM, RESPONSIVE TO
- 18 METAL, BRASS, CLASSICAL BRASSING ALUMINUM TRIM, RESPONSIVE TO
- 19 METAL, BRASS, CLASSICAL BRASSING ALUMINUM TRIM, RESPONSIVE TO
- 20 METAL, BRASS, CLASSICAL BRASSING ALUMINUM TRIM, RESPONSIVE TO
- 21 METAL, BRASS, CLASSICAL BRASSING ALUMINUM TRIM, RESPONSIVE TO
- 22 METAL, BRASS, CLASSICAL BRASSING ALUMINUM TRIM, RESPONSIVE TO
- 23 METAL, BRASS, CLASSICAL BRASSING ALUMINUM TRIM, RESPONSIVE TO
- 24 METAL, BRASS, CLASSICAL BRASSING ALUMINUM TRIM, RESPONSIVE TO
- 25 METAL, BRASS, CLASSICAL BRASSING ALUMINUM TRIM, RESPONSIVE TO
- 26 METAL, BRASS, CLASSICAL BRASSING ALUMINUM TRIM, RESPONSIVE TO
- 27 METAL, BRASS, CLASSICAL BRASSING ALUMINUM TRIM, RESPONSIVE TO
- 28 METAL, BRASS, CLASSICAL BRASSING ALUMINUM TRIM, RESPONSIVE TO
- 29 METAL, BRASS, CLASSICAL BRASSING ALUMINUM TRIM, RESPONSIVE TO
- 30 METAL, BRASS, CLASSICAL BRASSING ALUMINUM TRIM, RESPONSIVE TO
- 31 METAL, BRASS, CLASSICAL BRASSING ALUMINUM TRIM, RESPONSIVE TO
- 32 METAL, BRASS, CLASSICAL BRASSING ALUMINUM TRIM, RESPONSIVE TO
- 33 METAL, BRASS, CLASSICAL BRASSING ALUMINUM TRIM, RESPONSIVE TO
- 34 METAL, BRASS, CLASSICAL BRASSING ALUMINUM TRIM, RESPONSIVE TO
- 35 METAL, BRASS, CLASSICAL BRASSING ALUMINUM TRIM, RESPONSIVE TO
- 36 METAL, BRASS, CLASSICAL BRASSING ALUMINUM TRIM, RESPONSIVE TO
- 37 METAL, BRASS, CLASSICAL BRASSING ALUMINUM TRIM, RESPONSIVE TO
- 38 METAL, BRASS, CLASSICAL BRASSING ALUMINUM TRIM, RESPONSIVE TO
- 39 METAL, BRASS, CLASSICAL BRASSING ALUMINUM TRIM, RESPONSIVE TO
- 40 METAL, BRASS, CLASSICAL BRASSING ALUMINUM TRIM, RESPONSIVE TO
- 41 METAL, BRASS, CLASSICAL BRASSING ALUMINUM TRIM, RESPONSIVE TO
- 42 METAL, BRASS, CLASSICAL BRASSING ALUMINUM TRIM, RESPONSIVE TO
- 43 METAL, BRASS, CLASSICAL BRASSING ALUMINUM TRIM, RESPONSIVE TO
- 44 METAL, BRASS, CLASSICAL BRASSING ALUMINUM TRIM, RESPONSIVE TO
- 45 METAL, BRASS, CLASSICAL BRASSING ALUMINUM TRIM, RESPONSIVE TO
- 46 METAL, BRASS, CLASSICAL BRASSING ALUMINUM TRIM, RESPONSIVE TO
- 47 METAL, BRASS, CLASSICAL BRASSING ALUMINUM TRIM, RESPONSIVE TO
- 48 METAL, BRASS, CLASSICAL BRASSING ALUMINUM TRIM, RESPONSIVE TO
- 49 METAL, BRASS, CLASSICAL BRASSING ALUMINUM TRIM, RESPONSIVE TO
- 50 METAL, BRASS, CLASSICAL BRASSING ALUMINUM TRIM, RESPONSIVE TO
- 51 METAL, BRASS, CLASSICAL BRASSING ALUMINUM TRIM, RESPONSIVE TO
- 52 METAL, BRASS, CLASSICAL BRASSING ALUMINUM TRIM, RESPONSIVE TO
- 53 METAL, BRASS, CLASSICAL BRASSING ALUMINUM TRIM, RESPONSIVE TO
- 54 METAL, BRASS, CLASSICAL BRASSING ALUMINUM TRIM, RESPONSIVE TO
- 55 METAL, BRASS, CLASSICAL BRASSING ALUMINUM TRIM, RESPONSIVE TO
- 56 METAL, BRASS, CLASSICAL BRASSING ALUMINUM TRIM, RESPONSIVE TO
- 57 METAL, BRASS, CLASSICAL BRASSING ALUMINUM TRIM, RESPONSIVE TO
- 58 METAL, BRASS, CLASSICAL BRASSING ALUMINUM TRIM, RESPONSIVE TO
- 59 METAL, BRASS, CLASSICAL BRASSING ALUMINUM TRIM, RESPONSIVE TO
- 60 METAL, BRASS, CLASSICAL BRASSING ALUMINUM TRIM, RESPONSIVE TO
- 61 METAL, BRASS, CLASSICAL BRASSING ALUMINUM TRIM, RESPONSIVE TO
- 62 METAL, BRASS, CLASSICAL BRASSING ALUMINUM TRIM, RESPONSIVE TO
- 63 METAL, BRASS, CLASSICAL BRASSING ALUMINUM TRIM, RESPONSIVE TO
- 64 METAL, BRASS, CLASSICAL BRASSING ALUMINUM TRIM, RESPONSIVE TO
- 65 METAL, BRASS, CLASSICAL BRASSING ALUMINUM TRIM, RESPONSIVE TO
- 66 METAL, BRASS, CLASSICAL BRASSING ALUMINUM TRIM, RESPONSIVE TO
- 67 METAL, BRASS, CLASSICAL BRASSING ALUMINUM TRIM, RESPONSIVE TO
- 68 METAL, BRASS, CLASSICAL BRASSING ALUMINUM TRIM, RESPONSIVE TO
- 69 METAL, BRASS, CLASSICAL BRASSING ALUMINUM TRIM, RESPONSIVE TO
- 70 METAL, BRASS, CLASSICAL BRASSING ALUMINUM TRIM, RESPONSIVE TO
- 71 METAL, BRASS, CLASSICAL BRASSING ALUMINUM TRIM, RESPONSIVE TO
- 72 METAL, BRASS, CLASSICAL BRASSING ALUMINUM TRIM, RESPONSIVE TO
- 73 METAL, BRASS, CLASSICAL BRASSING ALUMINUM TRIM, RESPONSIVE TO
- 74 METAL, BRASS, CLASSICAL BRASSING ALUMINUM TRIM, RESPONSIVE TO
- 75 METAL, BRASS, CLASSICAL BRASSING ALUMINUM TRIM, RESPONSIVE TO
- 76 METAL, BRASS, CLASSICAL BRASSING ALUMINUM TRIM, RESPONSIVE TO
- 77 METAL, BRASS, CLASSICAL BRASSING ALUMINUM TRIM, RESPONSIVE TO
- 78 METAL, BRASS, CLASSICAL BRASSING ALUMINUM TRIM, RESPONSIVE TO
- 79 METAL, BRASS, CLASSICAL BRASSING ALUMINUM TRIM, RESPONSIVE TO
- 80 METAL, BRASS, CLASSICAL BRASSING ALUMINUM TRIM, RESPONSIVE TO
- 81 METAL, BRASS, CLASSICAL BRASSING ALUMINUM TRIM, RESPONSIVE TO
- 82 METAL, BRASS, CLASSICAL BRASSING ALUMINUM TRIM, RESPONSIVE TO
- 83 METAL, BRASS, CLASSICAL BRASSING ALUMINUM TRIM, RESPONSIVE TO
- 84 METAL, BRASS, CLASSICAL BRASSING ALUMINUM TRIM, RESPONSIVE TO
- 85 METAL, BRASS, CLASSICAL BRASSING ALUMINUM TRIM, RESPONSIVE TO
- 86 METAL, BRASS, CLASSICAL BRASSING ALUMINUM TRIM, RESPONSIVE TO
- 87 METAL, BRASS, CLASSICAL BRASSING ALUMINUM TRIM, RESPONSIVE TO
- 88 METAL, BRASS, CLASSICAL BRASSING ALUMINUM TRIM, RESPONSIVE TO
- 89 METAL, BRASS, CLASSICAL BRASSING ALUMINUM TRIM, RESPONSIVE TO
- 90 METAL, BRASS, CLASSICAL BRASSING ALUMINUM TRIM, RESPONSIVE TO
- 91 METAL, BRASS, CLASSICAL BRASSING ALUMINUM TRIM, RESPONSIVE TO
- 92 METAL, BRASS, CLASSICAL BRASSING ALUMINUM TRIM, RESPONSIVE TO
- 93 METAL, BRASS, CLASSICAL BRASSING ALUMINUM TRIM, RESPONSIVE TO
- 94 METAL, BRASS, CLASSICAL BRASSING ALUMINUM TRIM, RESPONSIVE TO
- 95 METAL, BRASS, CLASSICAL BRASSING ALUMINUM TRIM, RESPONSIVE TO
- 96 METAL, BRASS, CLASSICAL BRASSING ALUMINUM TRIM, RESPONSIVE TO
- 97 METAL, BRASS, CLASSICAL BRASSING ALUMINUM TRIM, RESPONSIVE TO
- 98 METAL, BRASS, CLASSICAL BRASSING ALUMINUM TRIM, RESPONSIVE TO
- 99 METAL, BRASS, CLASSICAL BRASSING ALUMINUM TRIM, RESPONSIVE TO
- 100 METAL, BRASS, CLASSICAL BRASSING ALUMINUM TRIM, RESPONSIVE TO

SEATING LEGEND

1 2 3 4 5 6 7 8 9 10 11 12 13 14 15 16 17 18 19 20 21 22 23 24 25 26 27 28 29 30 31 32 33 34 35 36 37 38 39 40 41 42 43 44 45 46 47 48 49 50 51 52 53 54 55 56 57 58 59 60 61 62 63 64 65 66 67 68 69 70 71 72 73 74 75 76 77 78 79 80 81 82 83 84 85 86 87 88 89 90 91 92 93 94 95 96 97 98 99 100

SCALE: 1/4" = 1'-0"

01 FURNISHINGS PLAN

CamargoCopeland
 14756 Paces Dr
 Suite 845
 Omaha, NE 68140
 972.834.7600 Tx
 972.834.7001 fax



MARKETPLACE GRILL
PERMIT REVIEW

JOPLIN, MISSOURI

PROJECT NUMBER: 01074-0008
 DATE: 11.21.10
 DRAWN BY: MJC
 CHECKED BY: MJC
 SCALE: AS SHOWN
 SHEET NUMBER: A3.0
 PLAN NUMBER: 01 FURNISHINGS PLAN

